

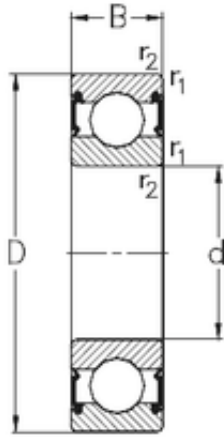

# NTN Bearing Manufacturing



60 mm x 95 mm x 18 mm NKE 6012-RS2 deep groove ball bearings

Bearing No. 6012-RS2

Size	60x95x18 mm
Bore Diameter	60 mm
Outer Diameter	95 mm
Width	18 mm
d	60 mm
D	95 mm
B	18 mm
C	18 mm
r1 min.	1,1 mm
r2 min.	1,1 mm
Weight	0,41 Kg
Basic dynamic load rating (C)	29,4 kN
Basic static load rating (C0)	23,2 kN

6012-RS2 Bearing 2D drawings and 3D CAD models