

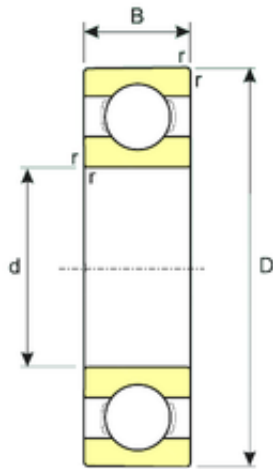

# NTN Bearing Manufacturing



800 mm x 980 mm x 57 mm ISB 608/800 deep groove ball bearings

Bearing No. 608/800

Size	800x980x57 mm
Bore Diameter	800 mm
Outer Diameter	980 mm
Width	57 mm
d	800 mm
D	980 mm
B	57 mm
C	57 mm
Weight	100 Kg
Basic dynamic load rating (C)	390 kN
Basic static load rating (C0)	990 kN
(Grease) Lubrication Speed	430 r/min

608/800 Bearing 2D drawings and 3D CAD models