

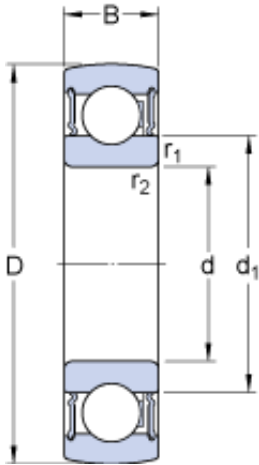

# NTN Bearing Manufacturing



35 mm x 80 mm x 21 mm SKF 1726307-2RS1  
deep groove ball bearings

Bearing No. 1726307-2RS1

1726307-2RS1 Bearing 2D drawings and 3D CAD models

Size	80x35x21 mm
Bore Diameter	80 mm
Outer Diameter	35 mm
Width	21 mm
d	35 mm
D	80 mm
B	21 mm
d <sub>1</sub>	49.56 mm
r <sub>1,2</sub> - min.	1.5 mm
Basic dynamic load rating - C	33.2 kN
Basic static load rating - C <sub>0</sub>	19 kN
Fatigue load limit - P <sub>u</sub>	0.815 kN
Limiting speed	6000 r/min
Calculation factor - f <sub>0</sub>	13
Category	Insert Bearings Spherical OD
Inventory	0.0
Manufacturer Name	SKF
Minimum Buy Quantity	N/A
Weight / Kilogram	0.4
EAN	7316577742940
Product Group	M06110
Inner Race Profile	Standard Inner Ring
Outer Race Profile	Spherical



## NTN Bearing Manufacturing

Relubricatable	No
Seal Type	RS1 Seal
Mounting Method	Shaft Mount
Rolling Element	Ball Bearing
Snap Ring	No
Long Description	35MM Bore; Standard Inner Ring; Ball Bearing; 21MM Length Thru Bore; 21MM Outer Race Width; 80MM Outside Diameter; Not Relubricatable; RS1 Seal Seal; Shaft Mount Mounting Method; No Snap Ring
Inch - Metric	Metric
Other Features	Single Row   Standard Duty   Metric
Category	Insert Bearings
UNSPSC	31171536
Harmonized Tariff Code	8482.10.50.00
Noun	Bearing
Keyword String	Insert
Manufacturer URL	<a href="http://www.skf.com">http://www.skf.com</a>
Manufacturer Item Number	1726307-2RS1
Weight / LBS	0.882
Outside Diameter	3.15 Inch   80 Millimeter
Bore	1.378 Inch   35 Millimeter
Outer Race Width	0.827 Inch   21 Millimeter
Length Thru Bore	0.827 Inch   21 Millimeter
bore diameter:	35 mm
radial static load capacity:	19 kN
outside diameter:	3.1496 in
finish/coating:	Uncoated
outer ring width:	49.5 mm
maximum rpm:	6000 RPM
bore type:	Round



## NTN Bearing Manufacturing

seal type:	Contact/Lip
operating temperature range:	-40 to +210 ° F
series:	17263
radial dynamic load capacity:	19 kN
$d_1$	49.56 mm
$r_{1,2}$ min.	1.5 mm
Basic dynamic load rating C	33.2 kN
Basic static load rating $C_0$	19 kN
Fatigue load limit $P_u$	0.815 kN
Limiting speed <sup>1)</sup>	6000 r/min
Calculation factor $f_0$	13
Mass complete bearing	0.44 kg