

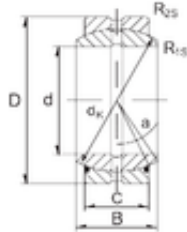

NTN Bearing Manufacturing

25 mm x 42 mm x 20 mm ZEN GE25ES plain bearings



Bearing No. GE25ES

Size	25x42x20 mm
Bore Diameter	25 mm
Outer Diameter	42 mm
Width	20 mm
d	25 mm
D	42 mm
B	20 mm
C	16 mm
dk	35,5 mm
r1 min.	0,6 mm
r2 min.	0,6 mm
Angle	7 °
Weight	0,119 Kg
Basic dynamic load rating (C)	48 kN

GE25ES Bearing 2D drawings and 3D CAD models