

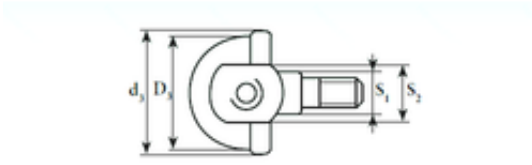

NTN Bearing Manufacturing

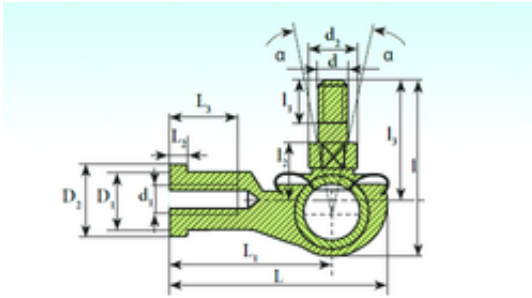

SQL 10 C RS Bearing 2D drawings and 3D CAD models

ISB SQL 10 C RS plain bearings

Bearing No. SQL 10 C RS

d	10 mm
S1	11 mm
L2	6,5 mm
L3	21 mm
l	50,5 mm
d2	14 mm
d3	30 mm
l1 min.	15 mm
l2 max.	17 mm
l3 min.	37 mm
D1	15 mm
D2	19 mm
D3	27 mm
L	57 mm
L1	43 mm
S2	17 mm
Thread (G)	M10x1,25
Angle	25 °
Weight	0,112 Kg
Basic dynamic load rating (C)	8,2 kN