

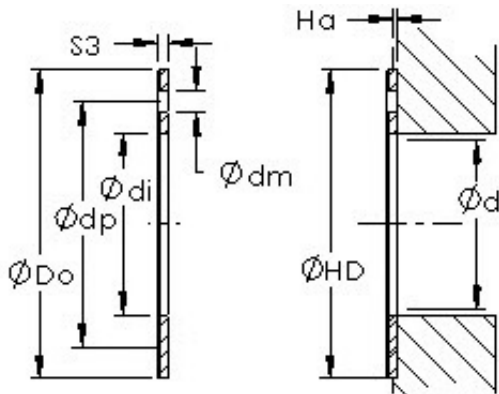

NTN Bearing Manufacturing



AST AST50 WC12IB plain bearings

Bearing No. AST50 WC12IB

| | |
|---|---------------|
| Bore Diameter | 19,05 mm |
| Bearing Type | thrust washer |
| Shaft Dia., Nominal (d) | 0.7500 |
| Bearing Outside Dia., Nominal (D) | 1.5000 |
| Washer Inside Diameter, Nominal (di) | 1 |
| Washer Inside Diameter Tolerance (di tol.) - +.010 / -0 | |
| Washer Outside Diameter, Nominal (Do) | 2 |
| Washer Outside Diameter Tolerance (Do tol.) - +0 / -.010 | |
| Washer Thickness, Nominal (S3) | 0 |
| Washer Thickness Tolerance (S3 tol.) - +.001 / -.001 | |
| Mounting Hole Dia. (dm) | 0.130 |
| Mounting Hole Pitch Dia. (dp) | 1.192 |
| Housing Counterbore Depth (Ha) | 0.04 |
| Housing Counterbore Depth Tolerance (Ha tol.) - +.010 / -.010 | |
| Housing Counterbore Diameter, Nominal (HD) | 1.500 |
| Housing Counterbore | +0.010 / 0 |

AST50 WC12IB Bearing 2D drawings and 3D CAD models



NTN Bearing Manufacturing

| | |
|---|---|
| Diameter Tolerance (HD tol.) - $+.010 / -0$ | |
| Material | Carbon steel shell with PTFE / Fiber lining |